

**Accessories**

1. Sump unit:  
 (optional: Drain trap: 30056  
 Silt bucket: 22515)

E 10610390

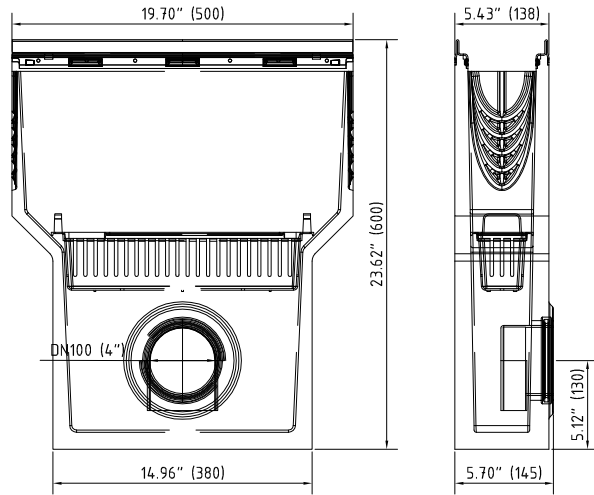

2. End cap:

19010215

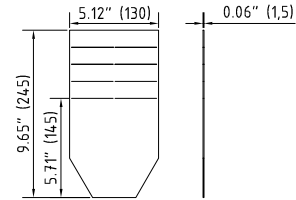

19010216

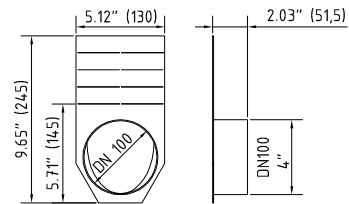

**Accessories FILCOTEN® pro – E 100 (4") – heavy duty series**

	Item Nno.	Accessories	Material	Weight	
				LBS	kg
<input type="radio"/>	10610390	Catch basin 6" with cast iron rails and 4" outlet with seal	FILCOTEN	71.43	32.4
<input type="radio"/>	22515	Sediment bucket for catch basin	plastic	0.44	0.2
<input type="radio"/>	19010215	Front/end cap galvanized steel (for channels 0 up to 20-0)	galvanized	0.66	0.3
<input type="radio"/>	19010204	4" No Hub bottom outlet	galvanized	0.66	0.3
<input type="radio"/>	19010216	4" No Hub end cap outlet	galvanized	1.10	0.5
<input type="radio"/>	19010915	Rebar support	fabricated steel	2.64	1.2
<input type="radio"/>	19010295	Step connector NW100 pro 0/10-0/20-0	galvanized	0.22	0.1

3. Anti-vandal locking device 32087:

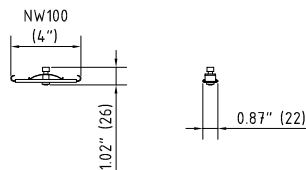

4. Rebar Support:

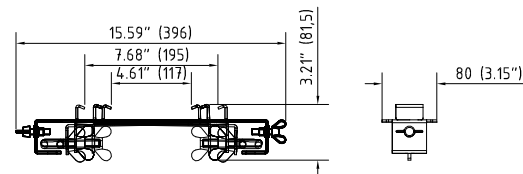

\* See detailed spec sheets for the Anti-vandal locking device and the Rebar support.