

Accessories

1. Sump unit: 10610292
 (including: Silt bucket: 22515)

V 10610290

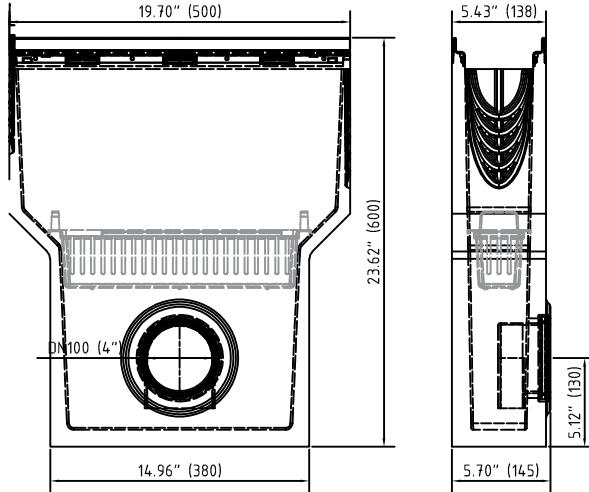

2. Front/End cap: 19010400

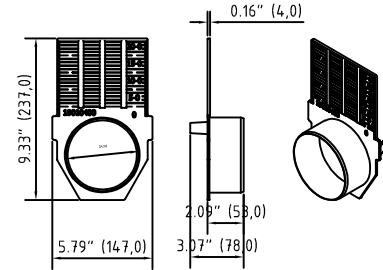

3. No Hub bottom outlet: 19011204

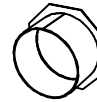

Accessories BG-FILCOTEN pro V 100 (4") – heavy duty series

| | Item Nno. | Accessories | Material | Weight | |
|-----------------------|-----------|---|------------|--------|------|
| | | | | LBS | kg |
| <input type="radio"/> | 10610292 | Catch basin KIT 4" with galvanized rails and 4" outlet with seal, including sediment bucket | FILCOTEN | 71.87 | 32.6 |
| <input type="radio"/> | 19010400 | Front/end cap | plastic | 0.26 | 0.1 |
| <input type="radio"/> | 19011204 | 4" No Hub bottom outlet | galvanized | 0.66 | 0.3 |
| <input type="radio"/> | 19010902 | Installation chair | galvanized | 1.37 | 0.6 |
| <input type="radio"/> | 19010295 | Step connector NW100 pro 0/10-0/20-0 | galvanized | 0.22 | 0.1 |
| <input type="radio"/> | 32087 | Anti-vandalism locking device NW 100 | | 0.22 | 0.1 |

4. Installation support: 19010902

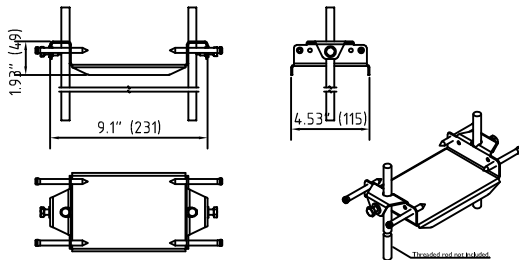

5. Step connector: 19010925

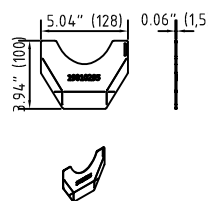

6. Anti-vandal locking device: 32087

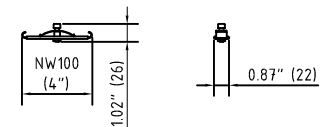

* See detailed spec sheets for the Anti-vandal locking device and the Rebar support.